

SAFETY

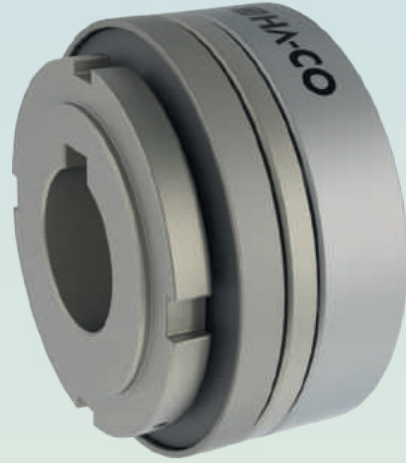

couplings

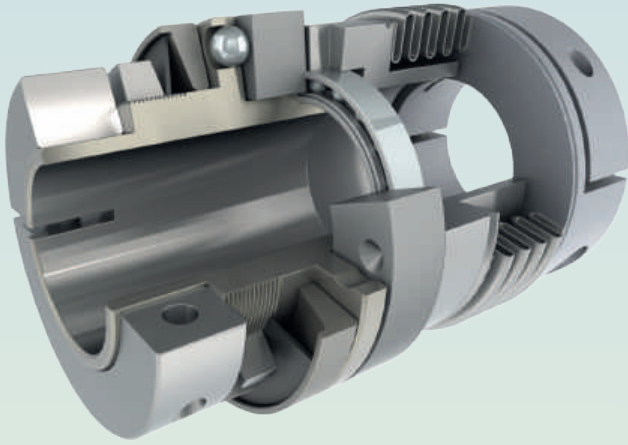

The brand for best couplings



feel the torque

The Motion Control Components

Zero backlash couplings

FEATURES

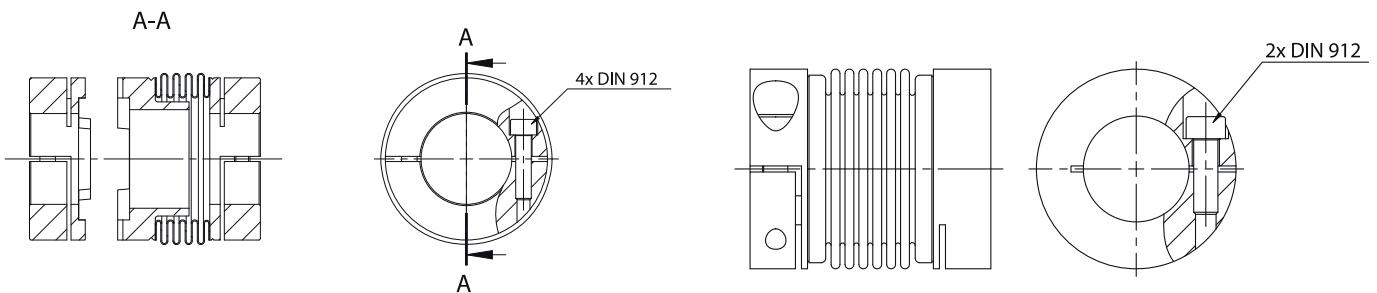
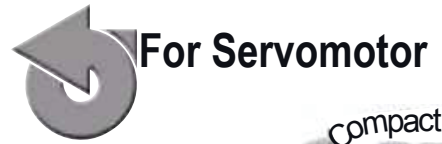
- Bellow type for high torque applications.
- High torsional stiffness, low inertia and excellent response.
- Applications for Servomotor.
- Misalignment compensation.
- Zero backlash.
- Hubs available in steel, aluminum and stainless steel.
- Temperature range 150°C.
- Torque up to 800 Nm.



Material		Finishes
Hub	Bellow	Clamping type
Aluminum alloy	Stainless steel	MKJ / MKS / MKA-S / CTB2 / MBB
Stainless steel	Stainless steel	MKE
Steel	Stainless steel	MKJ-S / MKS-S / MKK-S

MBB

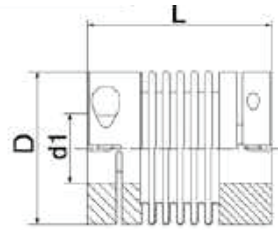

Model	Nominal Torque (Nm)	Diameter D	Length L	Min bore d1	Max bore d1
MBB-19C	1.5	19	30	3	8
MBB-27C	2.3	27	35	3	14
MBB-32C	4.5	32	46	5	16
MBB-40C	10	40	51	5	24

CTB

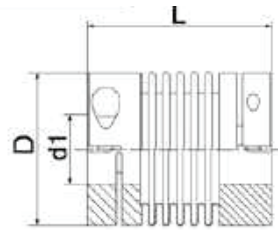

Model	Nominal Torque (Nm)	Diameter D	Length L	Min bore d1	Max bore d1
CTB-2-10	10	40	46	6	24
CTB-2-30	30	56	70	10	32
CTB-2-60	60	66	79	14	35
CTB-2-150	150	81,5	92	19	40
CTB-2-300	300	110	113	25	59
CTB-2-500	500	124	117	35	62
CTB-2-800	800	133	143	40	75

MK

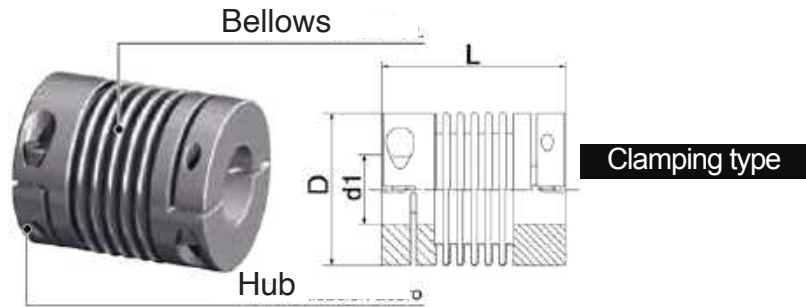

Model	Nominal Torque (Nm)	Diameter D	Length L	Min bore d1	Max bore d1
MKE-7	0,7	16	19	3	8
MKJ-7	0,7	16	32	3	8
MKS-8	0,8	16	37	3	8
MKE-14	1,4	16	21	3	8
MKJ-14	1,4	16	34	3	8
MKS-15	1,5	25	47	3	14
MKE-20	2	25	29	3	14
MKJ-20	2	25	43	3	14
MKS-30	3	25	47	3	14
MKE-50	5	25	30	4	14
MKJ-50	5	25	44	4	14
MKE-100	9	40	41	8	25
MKJ-100	10	40	58	8	25
MKS-130	13	40	63	8	20
MKE-150	15	40	42	12	25
MKJ-150	15	40	61	12	25
MKS-S-20	20	45	60	8	22
MKS-S-40	40	50	70	12	25
MKJ-S-15	15	56	65	12	26
MKA-S-15	15	56	72	11	30
MKS-S-60	60	63	72	15	35
MKJ-S-40	40	66	69	15	35
MKA-S-40	40	66	80	14	35
MKJ-S-60	60	66	70	18	35
MKA-S-60	60	66	81	18	35
MKA-S-100	100	82	94	17	43
MKA-S-150	150	82	95	22	43
MKJ-S-100	100	85	81	20	45
MKS-S-100	100	85	90	20	48
MKJ-S-150	150	85	82	20	45
MKS-S-150	150	90	92	24	55
MKJ-S-200	200	96	97	24	55
MKS-S-200	200	96	100	24	55
MKA-S-200	200	101	109	27	54
MKJ-S-350	350	116	103	28	60
MKJ-S-500	500	116	104	28	60
MKA-S-350	350	122	118	32	75
MKA-S-500	500	122	119	38	75

MKK-S

Metal bellow coupling MKK-S with clamping cone.



Material of hubs: Steel
Material of bellows: Stainless steel

- Backlash-free torque transmission
- Maintenance-free
- High torsional rigidity
- Small mass moment of inertia torque
- Compensation of alignment mistakes

MKK-S - 15

Nominal Torque 15 Nm

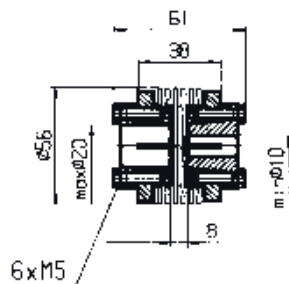

MKK-S - 40

Nominal Torque 40 Nm

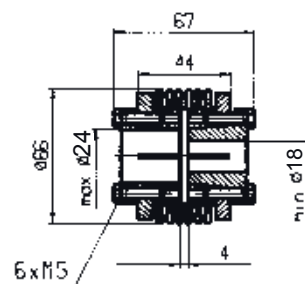

MKK-S - 60

Nominal Torque 60 Nm

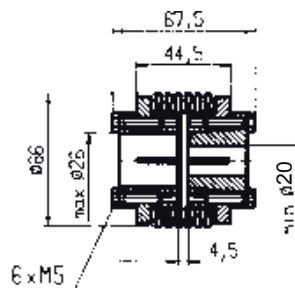

MKK-S - 100

Nominal Torque 100 Nm

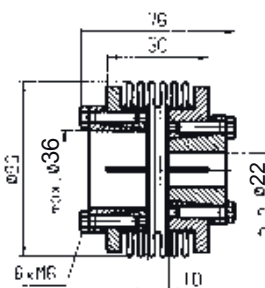

MKK-S - 150

Nominal Torque 150 Nm

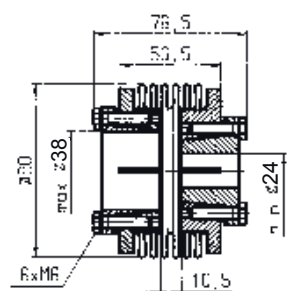

MKK-S - 200

Nominal Torque 200 Nm

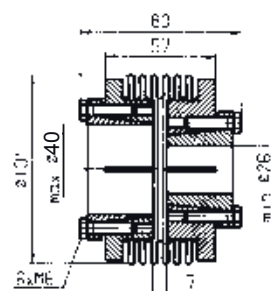

MKK-S - 350

Nominal Torque 350 Nm

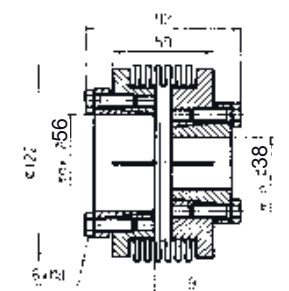

MKK-S - 500

Nominal Torque 500 Nm

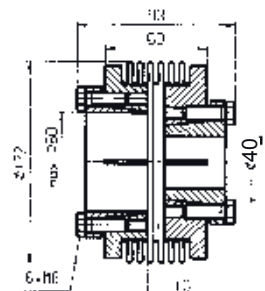

Safety couplings for direct drives

Safety coupling **FHW** consists on **GS** elastomer and clamping hub



FHW-F-SBK with clamping fixation.



OPTIONAL

FHW-C-SBK with pressure cone mounting.

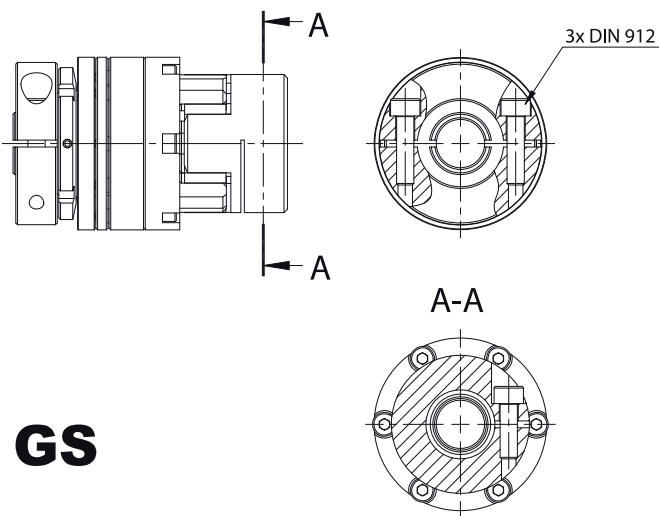

GS

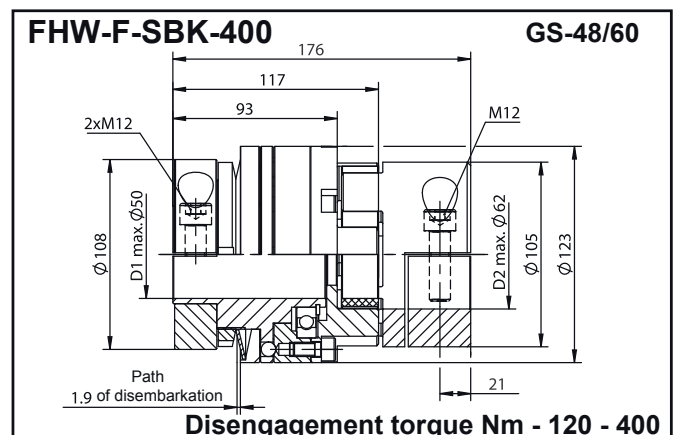
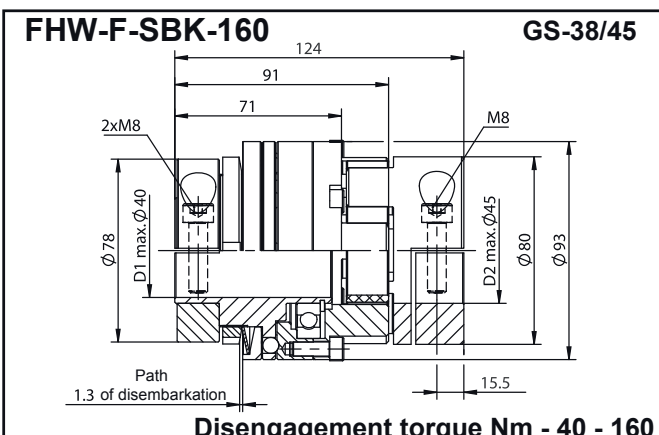
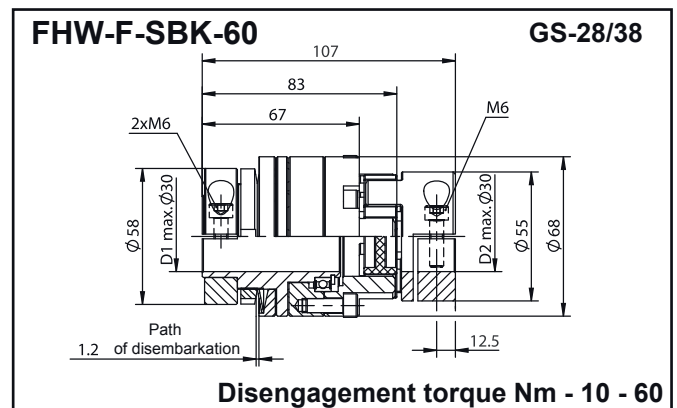
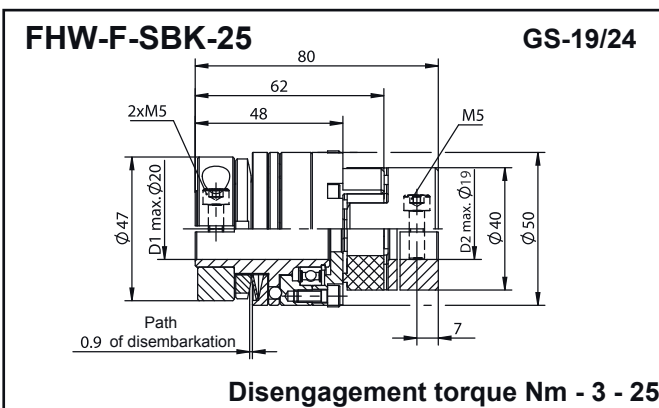
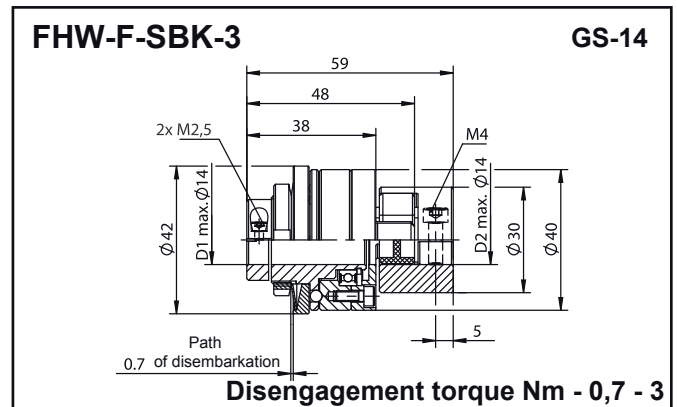

FHW-F-BA

Safety couplings for direct drives

Safety couplings **FHW-F-BA** are used for direct transmissions. It is composed by a safety coupling FHW-F-BA and a MKK-S metal bellow.

FHW-F-BA

coupling with clamping fixation



FHW-F-BA-3

Disengagement torque 0,7-3 Nm

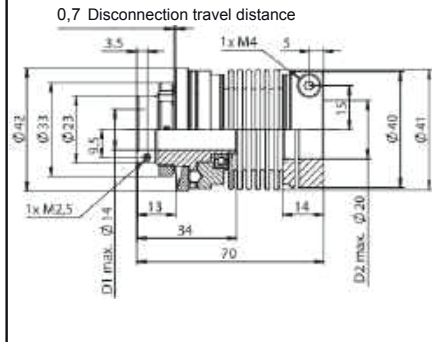

FHW-F-BA-25

Disengagement torque 3-25 Nm

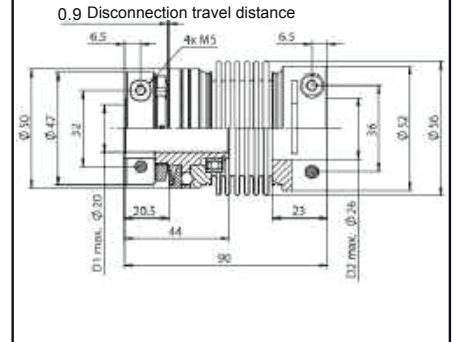

FHW-F-BA-60

Disengagement torque 10-60 Nm

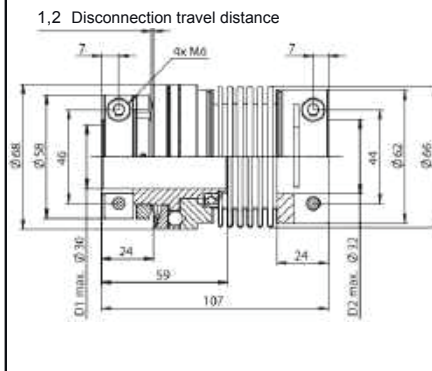

FHW-F-BA-160

Disengagement torque 40-160 Nm

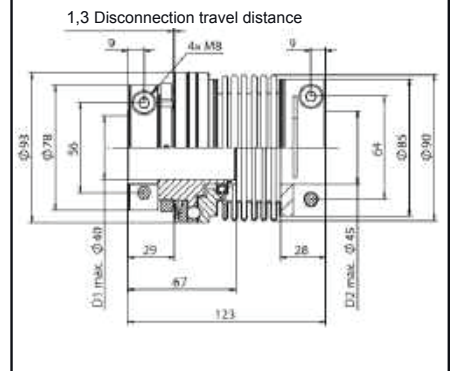

OPTIONAL

COUPLING FHW-F-SB

coupling with removable clamping fixation



FHW-F-BA-400

Disengagement torque 120-400 Nm

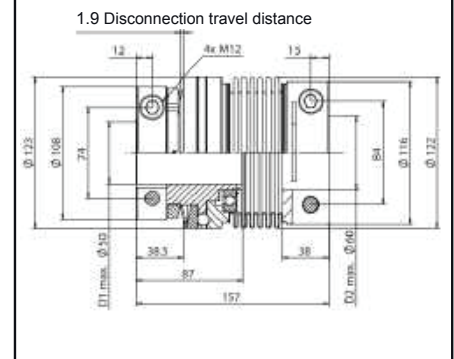

*Higher torque - upon request

Safety couplings for direct drives

Safety couplings **FHW-F-BA** are used for direct transmissions. It is composed by a safety coupling FHW-F-BA and a MKK-S metal bellow.

**OPTIONAL
UNDER
REQUEST**

FHW-C/BA with precision fixation,



FHW-C/BA 3

Disengagement torque 0,7-3 Nm*

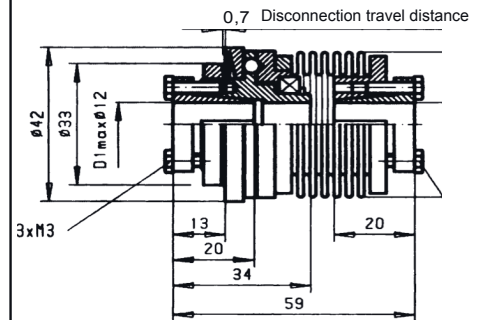

FHW-C/BA 25

Disengagement torque 3-25 Nm*

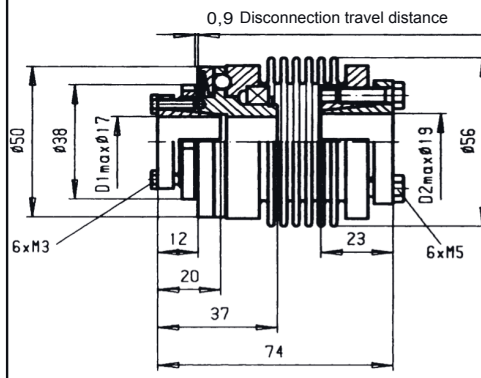

FHW-C/BA 60

Disengagement torque 10-60 Nm*

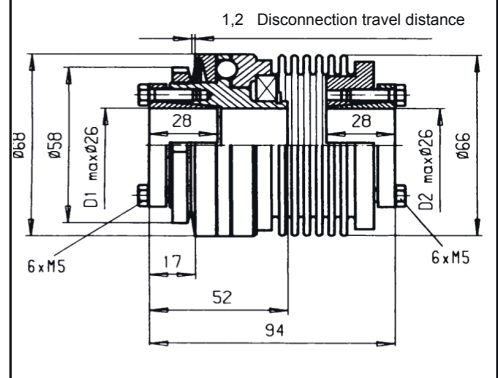

FHW-C/BA 160

Disengagement torque 40-160 Nm*

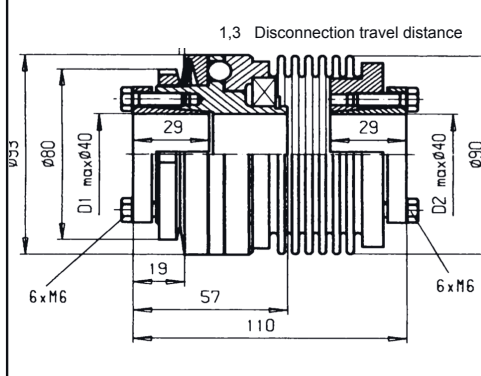

FHW-C/BA 400

Disengagement torque 120-400 Nm*

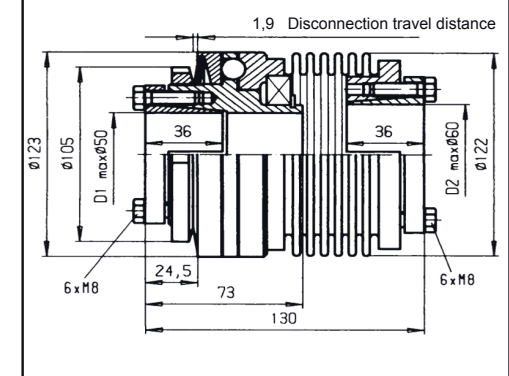

*Higher torque - upon request

COUPLINGS WITH SPACER

The HA-CO line shafts are made of different materials to bridge couplings axial distances up to 4000mm. They can be respectively used as play-free coupling distance connection, joint or synchronous shaft and replace conventional intermediate shafts. Misalignment can be compensated.

ALUMINIUM



SWA LINE SHAFTS

Light and with high torsional stiffness.

STEEL



SWS LINE SHAFTS

Strong and with high torsional stiffness.

STAINLESS STEEL



SWE LINE SHAFTS

For food industry, pharmaceutical industry and aggressive environments.

CARBON

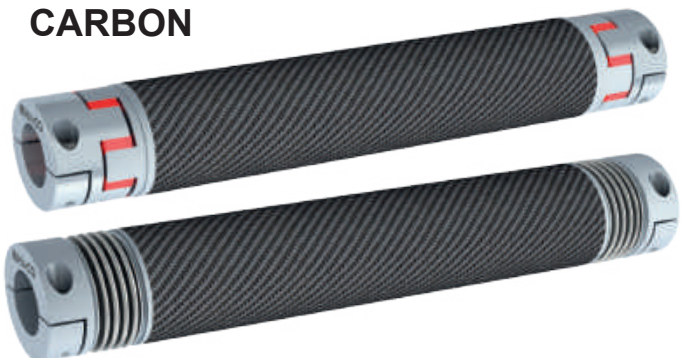

SWC LINE SHAFTS

Allows to reduce energy costs and to increase the efficiency.

RIGID COUPLINGS

CHARACTERISTICS

- High nominal torque without irregular rotations
- Maximum speed until 8.000 rpm
- Temperature range between -40°C and 175°C
- On request with keyway
- Special versions on request
- Compact design
- Easy, save and fast assembly
- Maintenance-free

Grooved rigid coupling (one piece) KSS / KSE / KSA

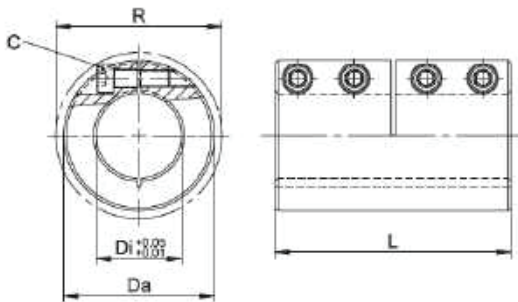

Rigid split coupling (two pieces) KTS / KTE / KTA

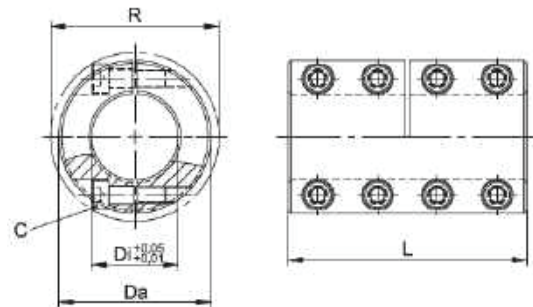

Ref	Dimensions (mm)				Torque (Nm)					
	Tipo	Di	Da	L	R	KSS	KSE	KSA	KTS	KTE
6	6	18	30	20,0	15	9	15	20	9	20
8	8	24	35	24,5	25	12	25	25	12	25
10	10	29	45	32,0	50	18	50	55	20	60
12	12	29	45	32,0	60	24	60	65	25	70
14	14	34	50	39,5	90	45	95	120	45	120
15	15	34	50	39,5	100	40	100	140	50	130
16	16	34	50	39,5	105	45	110	104	55	140
17	17	34	50	39,5	110	50	115	150	60	150
19	19	42	65	47,5	170	70	180	220	90	240
20	20	42	65	47,5	180	80	190	230	100	250
25	25	45	75	51,0	220	95	240	290	120	310
30	30	53	83	58,0	270	120	290	350	150	370
40	40	77	108	77,5	780	320	780	950	370	1000
50	50	85	124	91,0	1500	600	1600	1800	800	2000

Material	Type
Steel:	KSS, KTS,
Stainless Steel (V2A):	KSE, KTE,
Aluminum:	KSA, KTA

MOUNTING EXAMPLE

INDIRECT TRANSMISSION



DIRECT TRANSMISSION

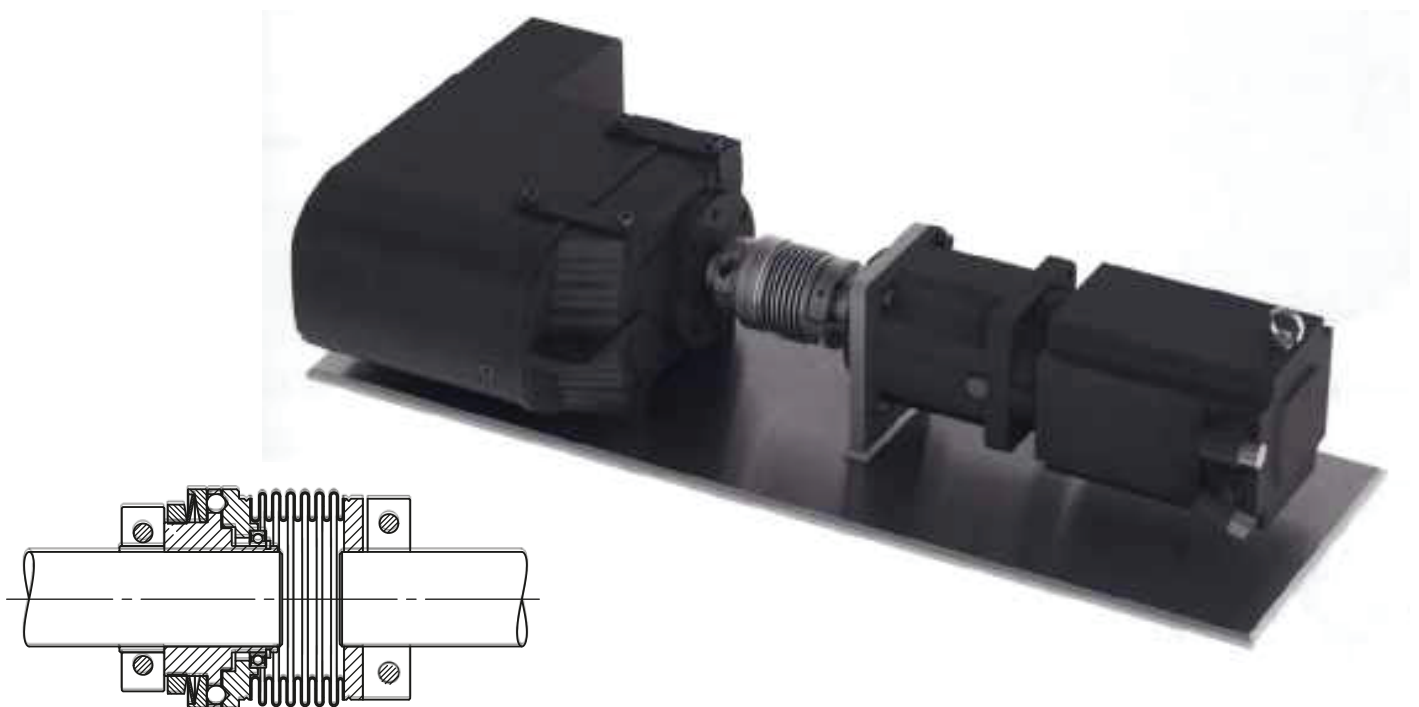

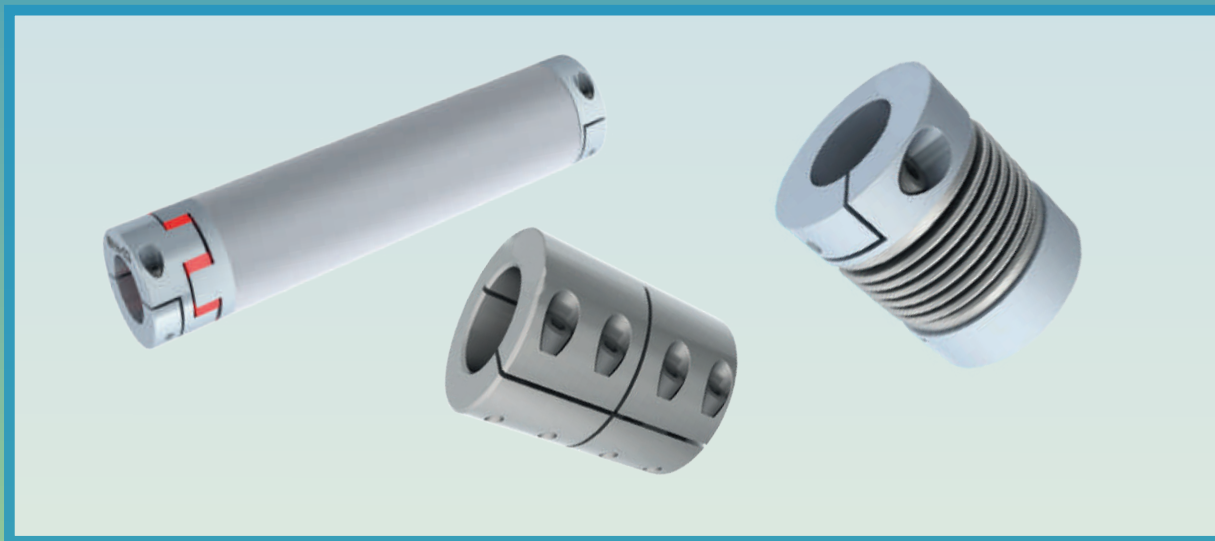

Tel. 973 71 18 84 - Fax 973 71 18 09
e-mail: lindis@lindis.es
www.lindis.com

Pol. Ind. Golparc - Av, d'Europa 18-20
25241 Golmés (Lleida)